

**LAUREL MUNICIPAL AIRPORT
AVAILABLE HANGAR LOCATION & SIZE
Updated June 2012**

ADDRESS	STREET	LOT DIMENSIONS (FT)	LOT SIZE (SF)	APRON (SF)	LEASE TYPE	MAXIMUM HANGAR SIZE		UTILITIES			COMMENT
						(FT.)	(S.F.)	Nat. Gas	Elec	Assessment	
2605	CORY	85 X 110	9350	7612	Commercial	75 X 100	7500	Yes	Yes	\$100 + \$3,473 Est.	Contact Airport for Special Conditions
2635	CORY	90 x 110	9900	7612	Commercial	80 x 100	8000	Yes	Yes	\$100 + \$3,473 Est.	Contact Airport for Special Conditions
2405	DeFRANCE	87.5 X 70	6125		GA	70 X 60	4200	Yes	Yes	\$100 + \$2,100	
2415	DeFRANCE	87.5 X 70	6125		GA	70 X 60	4200	Yes	Yes	\$100 + \$2,100	
2425	DeFRANCE	87.5 X 70	6125		GA	70 X 60	4200	Yes	Yes	\$100 + \$2,200	
2435	DeFRANCE	87.5 X 70	6125		GA	70 X 60	4200	Yes	Yes	\$100 + \$2,200	
2308	EAST GREENING	60 x 54	3240		GA	50 X 44	2200	Yes	Yes	\$100 + \$2,338	
2316	EAST GREENING	60 x 54	3240		GA	50 X 44	2200	Yes	Yes	\$100 + \$2,338	
2324	EAST GREENING	60 x 54	3240		GA	50 X 44	2200	Yes	Yes	\$100 + \$2,338	
2332	EAST GREENING	60 x 54	3240		GA	50 X 44	2200	Yes	Yes	\$100 + \$2,338	
2340	EAST GREENING	60 x 54	3240		GA	50 X 44	2200	Yes	Yes	\$100 + \$2,338	
2348	EAST GREENING	60 x 54	3240		GA	50 X 44	2200	Yes	Yes	\$100 + \$2,338	
9607	HERMAN CIRCLE	Contact Airport for Special Conditions			FBO	130 x 60	7800	Yes	Yes	Contact Airport for Special Conditions	
9615	HERMAN CIRCLE	Contact Airport for Special Conditions			FBO	100 x 75	7500	Yes	Yes	Contact Airport for Special Conditions	
2515	LEUTHOLD	90 x 90	8100		Limited Comm or GA	70 X 80	5600	No	No	N/A	Utilities and Assessments To Be Determined
2525	LEUTHOLD	90 x 90	8100		Limited Comm or GA	70 X 80	5600	No	No	N/A	Utilities and Assessments To Be Determined
2535	LEUTHOLD	90 x 90	8100		Limited Comm or GA	70 X 80	5600	No	No	N/A	Utilities and Assessments To Be Determined
2530	LEUTHOLD \ NOTTINGHAM	190 x 72.5	13775		Limited Comm or GA	180 x 62.5	11250	Yes	Yes	\$100 + \$3,473 Est.	Planned for 5 Bay T-Hangar Area
2244	WEST GREENING	60 x 46	2760		GA	50 X 36	1800	No	No	N/A	No Utilities Are Avilable
2250	WEST GREENING	60 x 46	2760		GA	50 X 36	1800	No	No	N/A	No Utilities Are Avilable
2258	WEST GREENING	60 x 46	2760		GA	50 X 36	1800	No	No	N/A	No Utilities Are Avilable
2260	WEST GREENING	60 x 46	2760		GA	50 X 36	1800	No	No	N/A	No Utilities Are Avilable

Hangar Ground Lease Rates	Annual Rates (Based on Lot Size)
General Aviation Ground Leases	\$0.14
Commercial / FBO Ground Leases	\$0.10
Vehicle Parking Areas	\$0.03
Apron and Tie Down Areas	\$0.03

Utility assessments are a one-time charge to cover the cost of the intallation of the utilities.

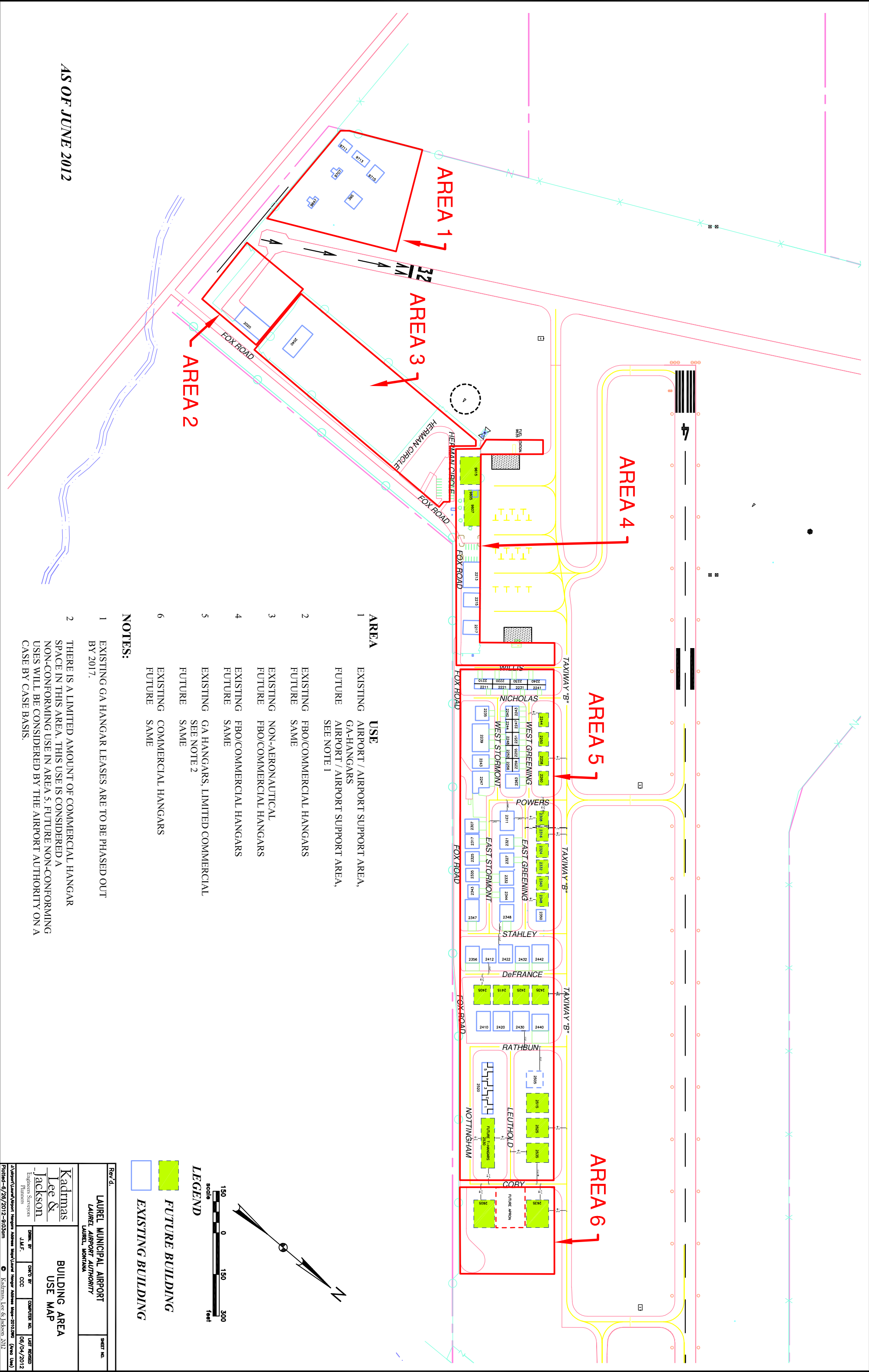

AREA	USE
1	EXISTING AIRPORT / AIRPORT SUPPORT AREA, GA-HANGARS FUTURE AIRPORT / AIRPORT SUPPORT AREA, SEE NOTE 1
2	EXISTING FBO/COMMERCIAL HANGARS FUTURE SAME
3	EXISTING NON-AERONAUTICAL FUTURE FBO/COMMERCIAL HANGARS
4	EXISTING FBO/COMMERCIAL HANGARS FUTURE SAME
5	EXISTING GA HANGARS, LIMITED COMMERCIAL FUTURE SAME
6	EXISTING COMMERCIAL HANGARS FUTURE SAME

NOTES:

- EXISTING GA HANGAR LEASES ARE TO BE PHASED OUT BY 2017.
- THERE IS A LIMITED AMOUNT OF COMMERCIAL HANGAR SPACE IN THIS AREA. THIS USE IS CONSIDERED A NON-CONFORMING USE IN AREA 5; FUTURE NON-CONFORMING USES WILL BE CONSIDERED BY THE AIRPORT AUTHORITY ON A CASE BY CASE BASIS.

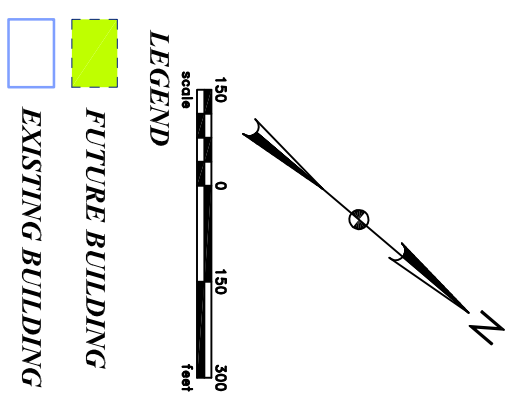

AS OF JUNE 2012

Rev'd.	LAUREL MUNICIPAL AIRPORT LAUREL AIRPORT AUTHORITY LAUREL, MONTANA	SHEET NO.
Kadmas Lee & Jackson Engineers Surveyors Planners		BUILDING AREA USE MAP
DRAWN BY: J.M.F. CHECKED BY: J.M.F.	CADD BY: J.M.F. DATE: 06/04/2012	USBT REVISION NO. 06/04/2012 PLOTTED: 6/26/2012 9:03am Plotted: 6/26/2012 9:03am

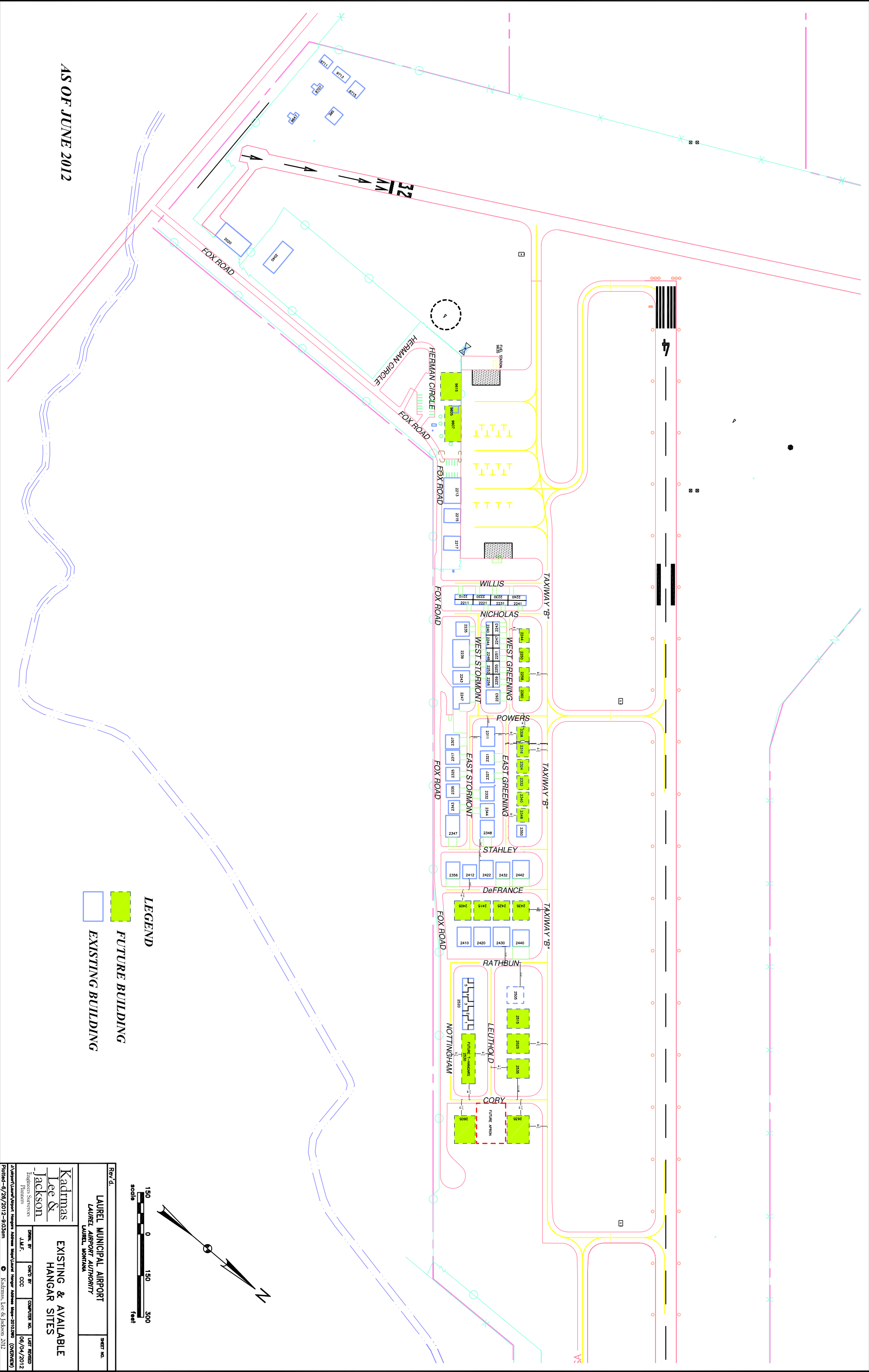

LEGEND

FUTURE BUILDING

EXISTING BUILDING

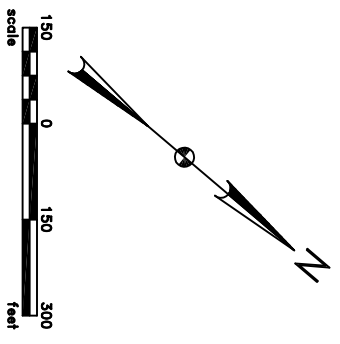

AS OF JUNE 2012

Rev'd.	LAUREL MUNICIPAL AIRPORT LAUREL AIRPORT AUTHORITY LAUREL, MONTANA		SHEET NO.
EXISTING & AVAILABLE HANGAR SITES			
Kadmas Lee & Jackson Engineers Surveyors Planners		DATE PLOTTED 06/04/2012	DATE REVISION (OVERVIEW)
DRAWN BY J.M.F.	CHECKED BY C.C.C.	COMPUTER NO.	LAST REVISION
<small> A:\Airport\Laurel\Airport Hangars Address Map\Laurel Hangar Address Map-201206 (OVERVIEW) Plotted-6/26/2012-9:03am © Kadmas, Lee & Jackson 2012 </small>			

AS OF JUNE 2012

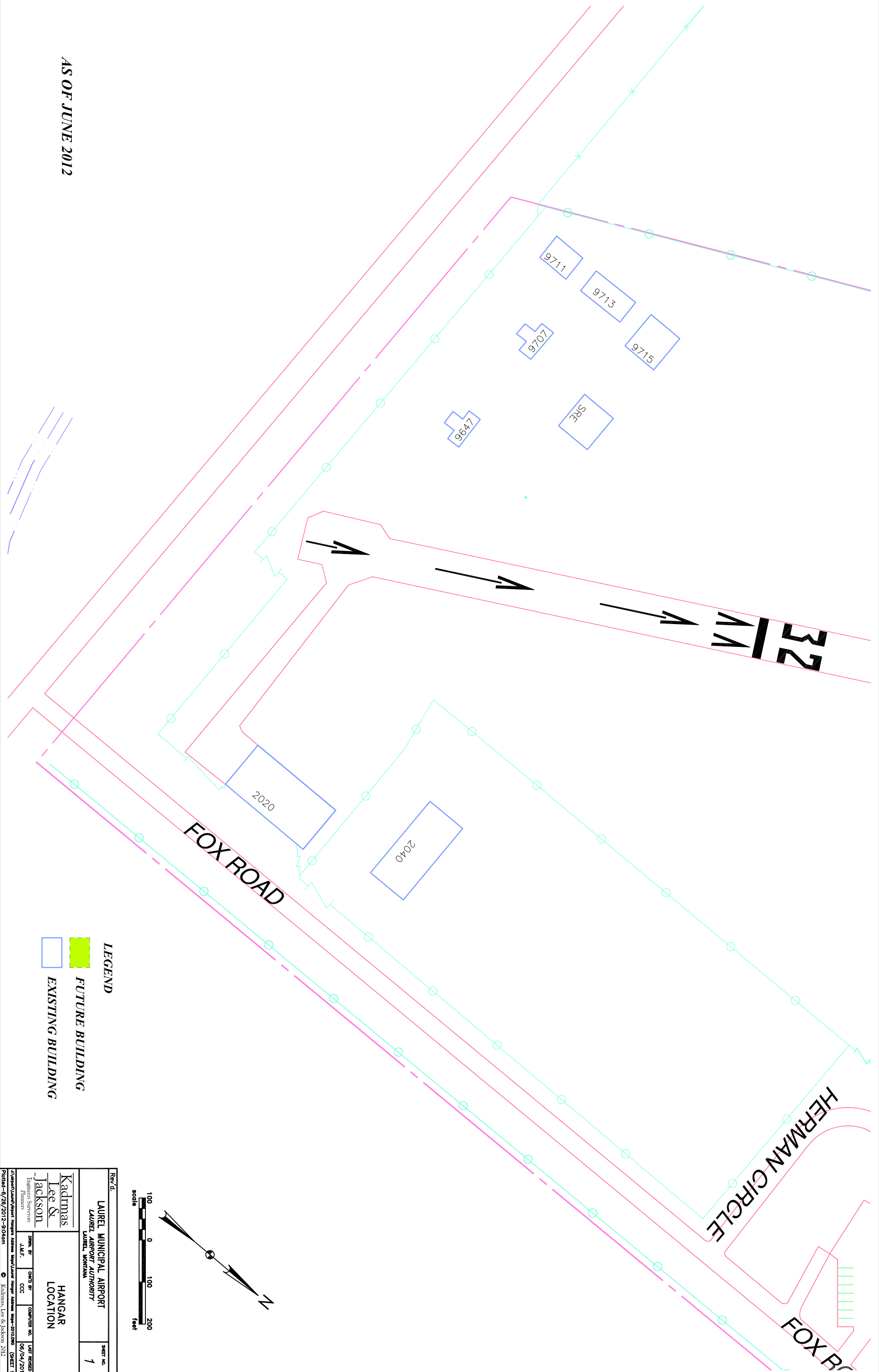

LEGEND

FUTURE BUILDING

EXISTING BUILDING

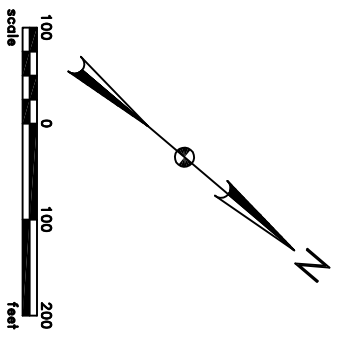

Rev'd.		LAUREL MUNICIPAL AIRPORT		SHEET NO.
LAUREL AIRPORT AUTHORITY		LAUREL, MONTANA		1
Kadmas Lee & Jackson Engineers Surveyors Planners		HANGAR LOCATION		
DATE: 06/29/2012	BY: J.M.F.	DATE: 06/29/2012	BY: J.M.F.	
PROJECT: 9044m	CLIENT: CAC	PROJECT: 9044m	CLIENT: CAC	
Plotted: 6/29/2012-9:04am		Kadmas, Lee & Jackson 2012		

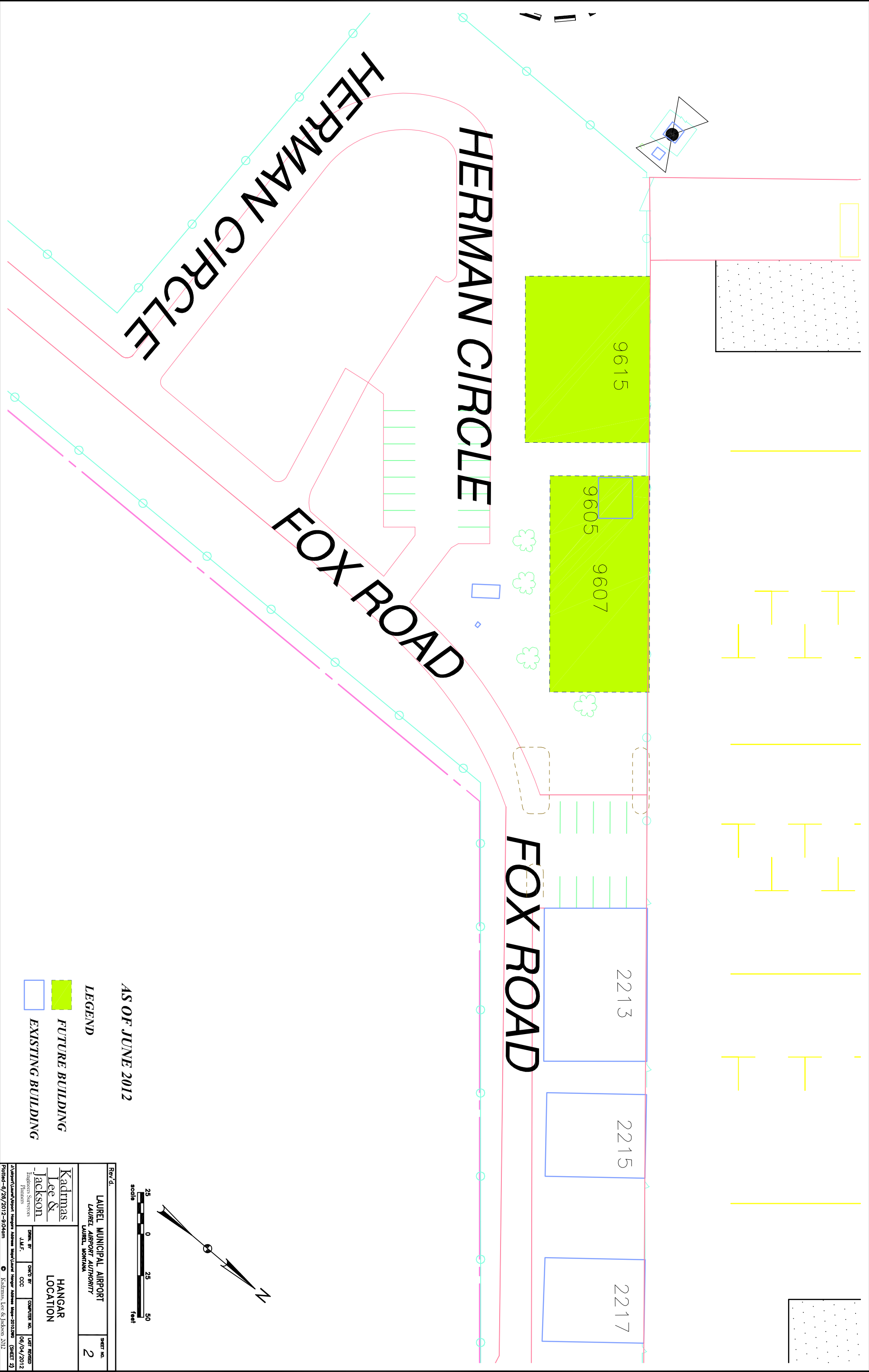

HERMAN CIRCLE

HERMAN CIRCLE

FOX ROAD

FOX ROAD

9615

9605

9607

2213

2215

2217

AS OF JUNE 2012

LEGEND

FUTURE BUILDING

EXISTING BUILDING

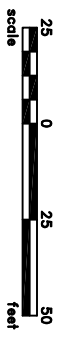

Rev'd.	LAUREL MUNICIPAL AIRPORT	SHEET NO.	2
	LAUREL AIRPORT AUTHORITY		
	LAUREL, MONTANA		
Kadmas Lee & Jackson Engineers Surveyors Planners	HANGAR LOCATION	DATE REVISION	
DRWG. BY J.M.F.	CHKD. BY COC	COMPUTER NO.	106/04/2012
<small> \A:\projects\Laurel\Airport\Hangar\Address Map\Laurel\Hangar\Map-201202.mxd (SHEET 2) Plotted-6/26/2012-9:04am </small>			

TAXIWAY "B"

WILLIS

NICHOLAS

WEST GREENING

WEST STORMONT

POWERS

FOX ROAD

5
22117

2240	2230	2220	2210
12241	12231	12221	11221

2244
35.0' min

2250

2258
65.5' min

2260

2240

2244

2248

2252

2256

2256

2235

2239

2243

2247

702

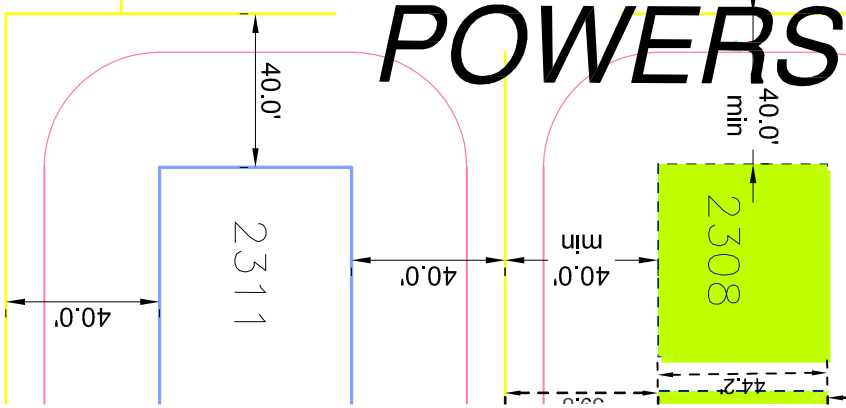

AS OF JUNE 2012

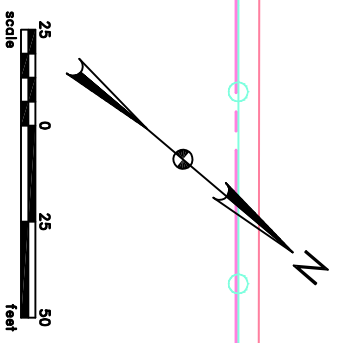

LEGEND

	FUTURE BUILDING
	EXISTING BUILDING

Rev'd.	LAUREL MUNICIPAL AIRPORT LAUREL AIRPORT AUTHORITY LAUREL, MONTANA	SHEET NO. 3
Kadmas Lee & Jackson Engineers Surveyors Planners	HANGAR LOCATION	DATE REVISION 10/04/2012
Drawn by: J.M.F.	Checked by: J.M.F.	Computer No.:
Project: 6-26/2012-9046m	Client: Kadmas, Lee & Jackson 2012	Sheet: 3

3"

TAXIWAY "B"

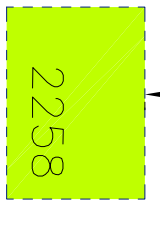
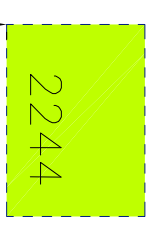

65.5' min

35.0' min

WEST GREENING

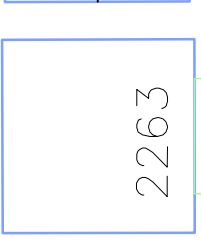
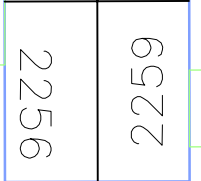
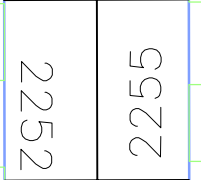
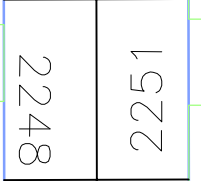
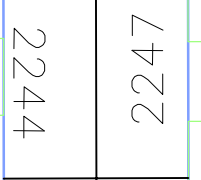
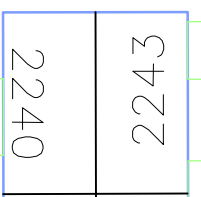

WEST STORMONT

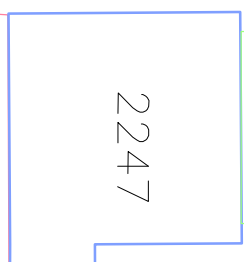
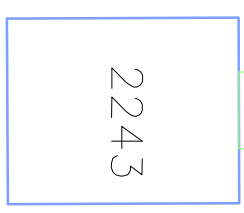
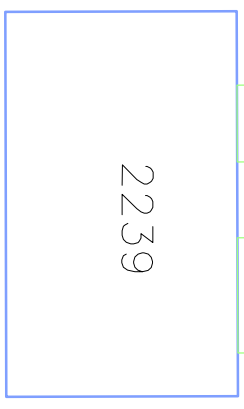
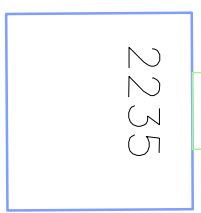

POWERS

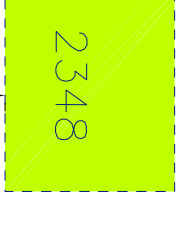
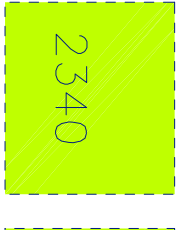
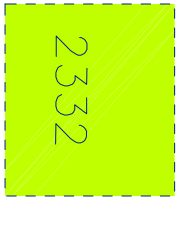
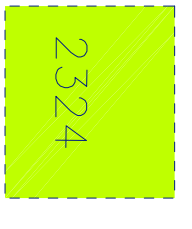
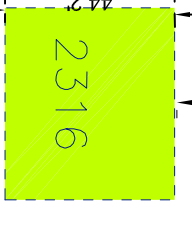
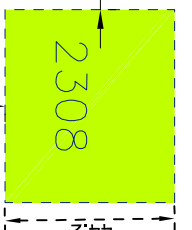

66.1' min

40.0' min

40.0' min

40.0'

EAST GREENING

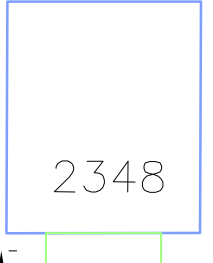
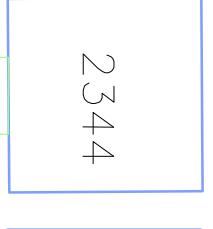
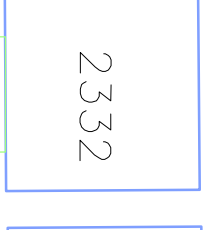
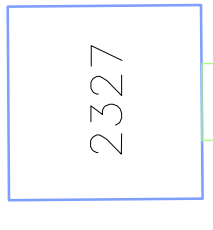
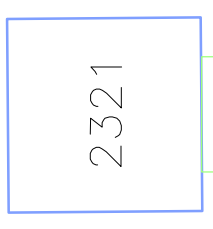
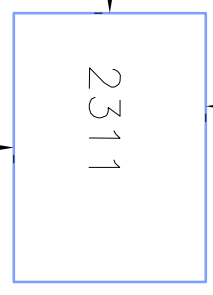

EAST STORMONT

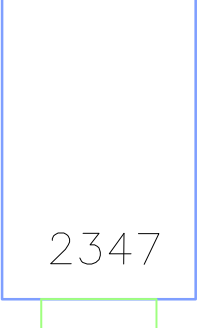
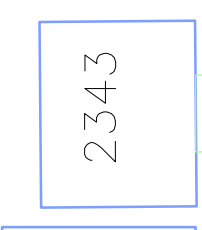
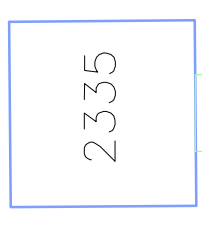
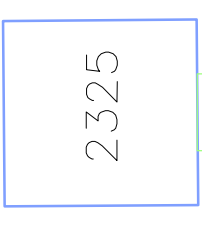
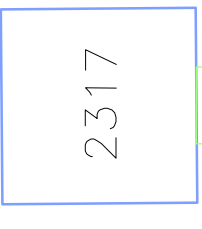
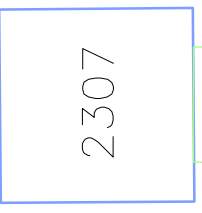

FOX ROAD

ROAD

AS OF JUNE 2012

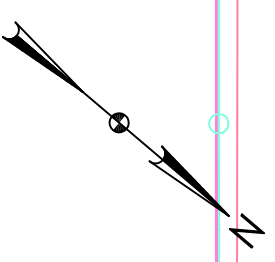

LEGEND

FUTURE BUILDING

EXISTING BUILDING

Rev'd.	LAUREL MUNICIPAL AIRPORT	SHEET NO.	4
	LAUREL AIRPORT AUTHORITY		
	LAUREL, MONTANA		
	Kadmas Lee & Jackson	HANGAR LOCATION	
	Engineers Surveyors Planners		
DATE	BY	CHECKED	DATE
06/04/2012	J.M.F.	COC	06/04/2012
LAUREL MUNICIPAL AIRPORT		COMPUTER NO.	106/04/2012
LAUREL AIRPORT AUTHORITY		PROJECT NO.	106/04/2012
LAUREL, MONTANA		DATE	06/04/2012
Plotted: 6/26/2012-9:04am		BY	Kadmas Lee & Jackson 2012

Y "B"

TAXIWAY "B"



40.0' min

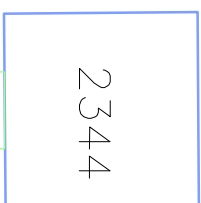

40.0'

ARMONT

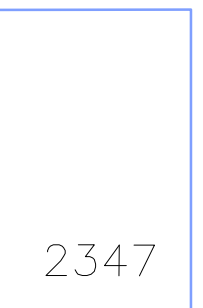
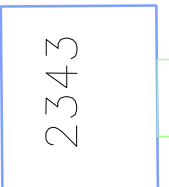
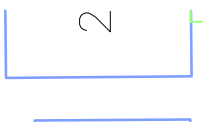

STAHLEY

40.0'



40.0'

DeFRANCE

40.0' min



65.5' min

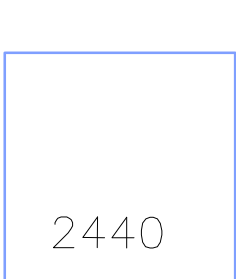
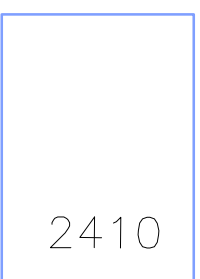

57.5'

RATHBUN

87.5'

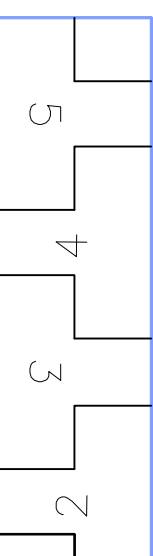
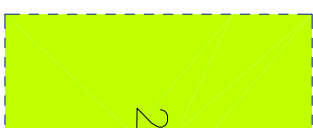
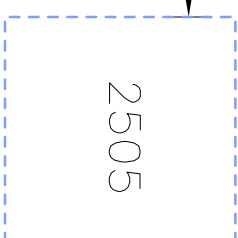

RD

FOX ROAD

AS OF JUNE 2012

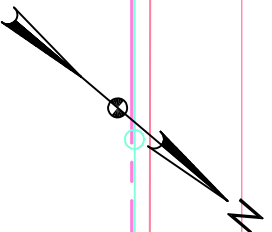

LEGEND

FUTURE BUILDING

EXISTING BUILDING

Rev'd.	LAUREL MUNICIPAL AIRPORT	SHEET NO.
	LAUREL AIRPORT AUTHORITY	5
	LAUREL, MONTANA	

Kadmas Lee & Jackson Engineers Surveyors Planners	HANGAR LOCATION
---	--------------------

DATE	BY	DATE	BY
10/04/2012	J.M.F.	06/04/2012	J.M.F.
10/04/2012	C.C.C.		
06/04/2012	C.C.C.		

Plotted: 6/26/2012-9:04am

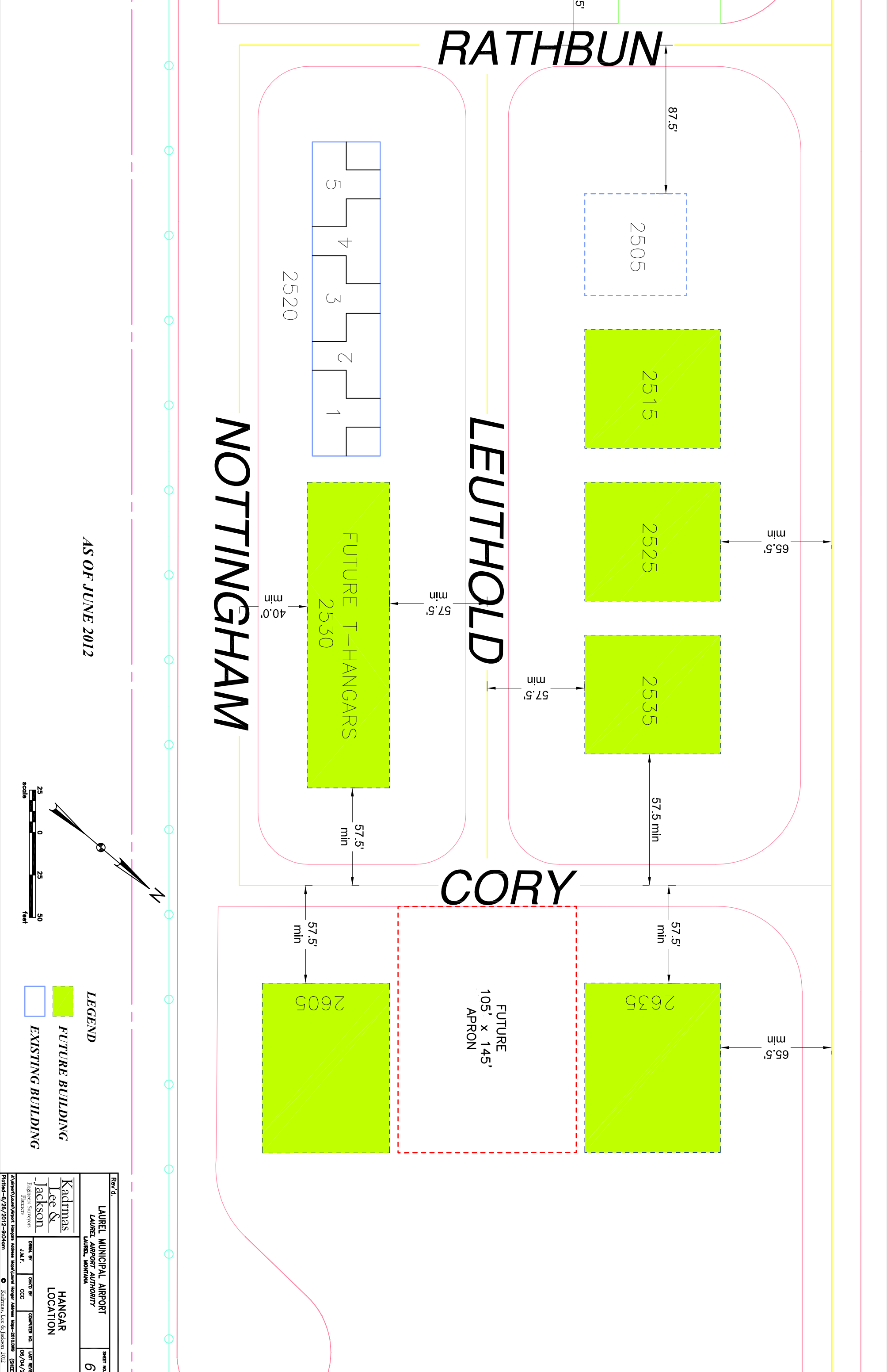

AS OF JUNE 2012

LAUREL MUNICIPAL AIRPORT LAUREL AIRPORT AUTHORITY LAUREL, MONTANA	SHEET NO. 6
Kadmas Lee & Jackson Engineers Surveyors Planners	HANGAR LOCATION
DATE PLOTTED: 06/04/2012	PROJECT: 06/04/2012
PLOTTED: 06/29/2012-904dm	© Kadmas, Lee & Jackson 2012